



**ProFlex—smart wiring reimaged.**  
**Modular. Efficient. Space-saving.**



Further  
information

**PROMET** 

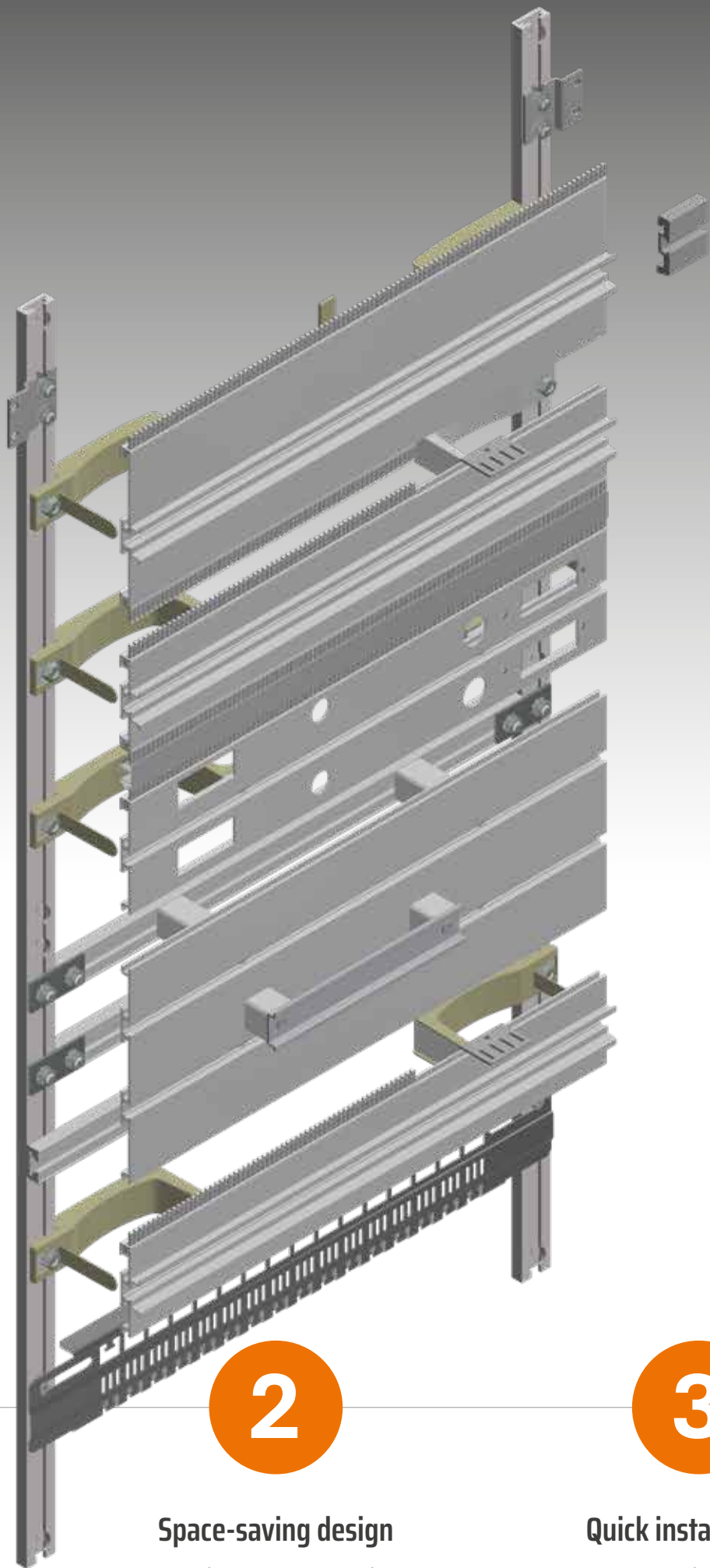

1

### **Modular & flexible**

Adapts to every requirement

2

### **Space-saving design**

Maximum space gain

3

### **Quick installation**

Less downtime, more productivity

Lean solution

## 3D system – revolutionising control engineering!

**With ProFlex, you can calmly face any requirement in the control cabinet.**

With ProFlex, we have combined all the advantages of existing wiring systems in one.

ProFlex is more than just an alternative. ProFlex is the answer to the question of optimisation in control cabinet wiring and the corresponding cost reduction.

More compact designs and reduced space in machines and systems are challenges for control technology when integrating into individual enclosure solutions.

The revolutionary ProFlex wiring system has a modular and flexible design and fits into all control cabinets, wall and small enclosures, as well as customer-specific elements such as direct integration into machines, machine stands, etc.

We have our own production facility, enabling us to respond quickly and efficiently to your individual needs.

The ProFlex wiring system is approved and certified for worldwide use.

4

### **Efficient & economical**

Reduces time and costs in  
the long term

## Construction and installation

# A new approach to open space – with the ProFlex system.

**With ProFlex, you can calmly face any requirement in the control cabinet.**

With ProFlex, we have combined all the advantages of existing wiring systems in one.

ProFlex is more than just an alternative. ProFlex is the answer to the question of optimisation in control cabinet wiring and the corresponding cost reduction.

More compact designs and reduced space in machines and systems are challenges for control technology when integrating into individual enclosure solutions.

The revolutionary ProFlex wiring system has a modular and flexible design and fits into all control cabinets, wall and small enclosures, as well as customer-specific elements such as direct integration into machines, machine stands, etc.

We have our own production facility, enabling us to respond quickly and efficiently to your individual needs.

The ProFlex wiring system is approved and certified for worldwide use.

- 1 Horizontal profiles
- 2 Vertical profiles
- 3 Top-hat rails
- 4 Mounting brackets / spacer profiles
- 5 Wiring combs
- 6 Plastic covers

All of our profiles are available individually. The height and length are customised to each customer's requirements and available in any size.

All plastics are halogen-free. This means that ProFlex can be used in public buildings or structures where halogen-free plastics are required.



Detailed overview

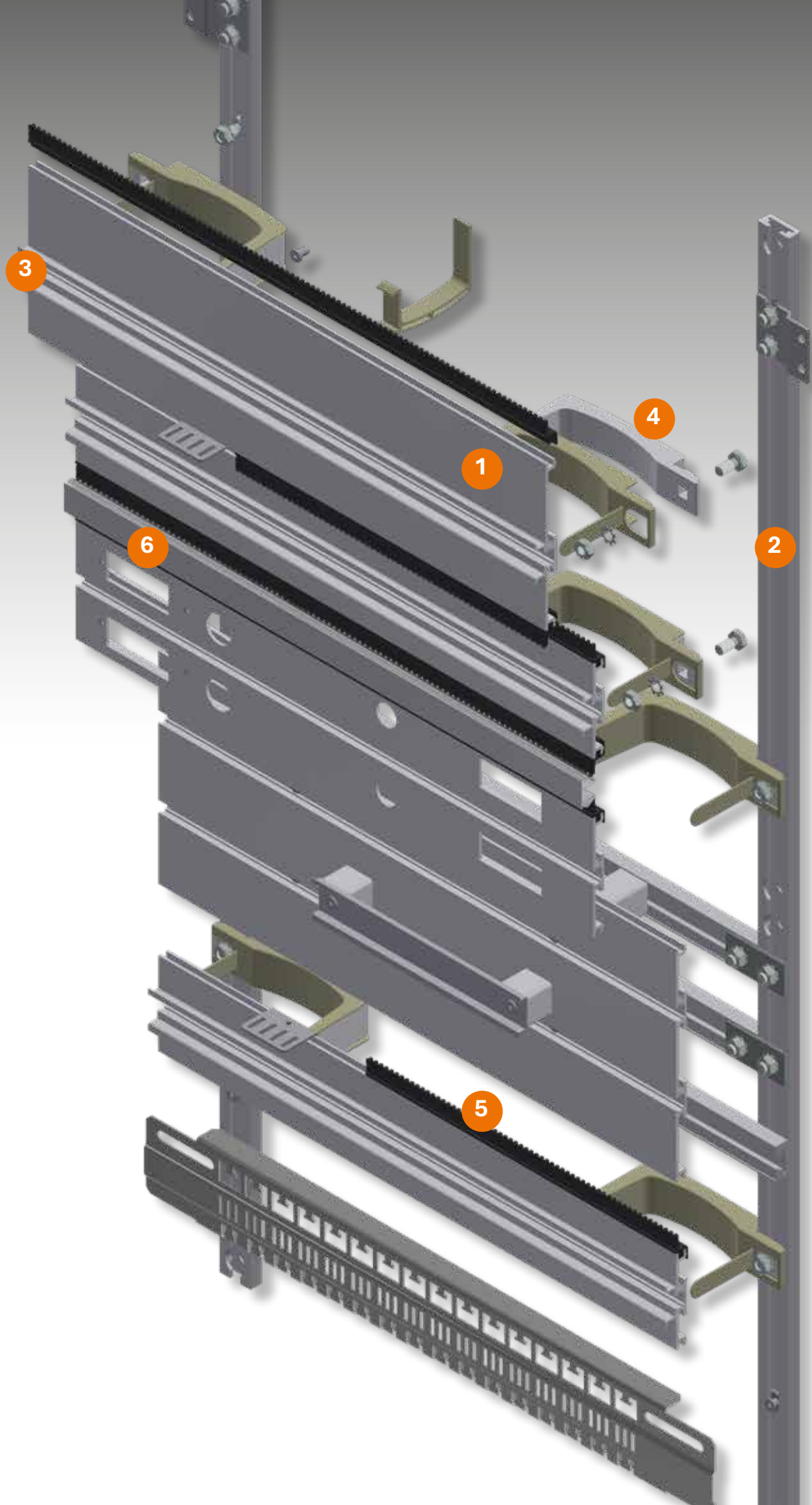





## Greater efficiency, less effort – that's modern wiring!



**-30%**

Less weight compared to  
conventional mounting  
plate solutions

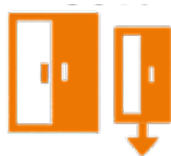

**-35%**

Space savings thanks to compact  
design and no cable ducts



**-25%**

Reduction in ladder lengths  
thanks to more compact design



Economically optimal

**Reduce costs.**

### Transport and packaging costs

Our compact wiring systems offer you advantages in terms of transport and packaging.

A complete project implemented with ProFlex is significantly more compact and therefore requires less loading space on transport vehicles and less effort in terms of packaging.

Compared to a conventional control cabinet, you save 30% in transport costs!

### Logistics processes

You receive a complete wiring frame in the goods receiving department and can start assembling and wiring the electrical components straight away. Don't waste time with internal material provision and reduce your storage costs.



## Conventional control cabinets V ProFlex

# More compact. More efficient. More economical.

Compared to conventional control cabinets, our control cabinet solutions are significantly more compact – this saves space during installation, reduces transport and purchasing costs, and creates new freedom in planning.

By completely eliminating cable ducts and apparatus rails, not only is mechanical processing such as drilling or cutting to length no longer necessary, but

wiring is also significantly accelerated. Depending on the application, this can save several hours of installation time.

Individually customisable with stainless steel enclosures or customer-specific colours – efficient from the outset, economical down to the last detail.

**plus**

### Control engineering

- + Reduction in space requirements
- + Reduction in ladder lengths
- + Reduction in purchasing costs

**plus**

### Machine manufacturer

- + 30% kleinerer Schaltschrank
- + EMV-Vorteile
- + Reduktion Transportkosten

**plus**

### Endkunde

- + 30% less floor space
- + less space required



Faster wiring

# Time for other things.

With the ProFlex system, you can save up to 30% of your time thanks to its simple installation and quick wiring. Whether horizontal or vertical, the system adapts perfectly to your requirements and enables flexible wiring according to your needs.

The mounting frames are quick and easy to assemble thanks to their screw-fastened design – robust, precise and maintenance-friendly.

The strands fixed in the wiring combs make it much easier to replace components and ensure clear, structured cable routing.

Thanks to optimum accessibility with double-sided construction, the installation remains clear and service-friendly at all times.



Thermally optimised

# Conduit-free wiring system

By dispensing with conventional cable ducts, the wiring system can be made up to 35% more compact overall. The resulting free space allows for a thermally optimised and less congested arrangement of components or enables the use of a correspondingly smaller control cabinet.



Comparison: Conventional design versus a channel-free, thermally optimised wiring system



Longer service life thanks to improved air flow

# Optimal solution for heating in the control cabinet

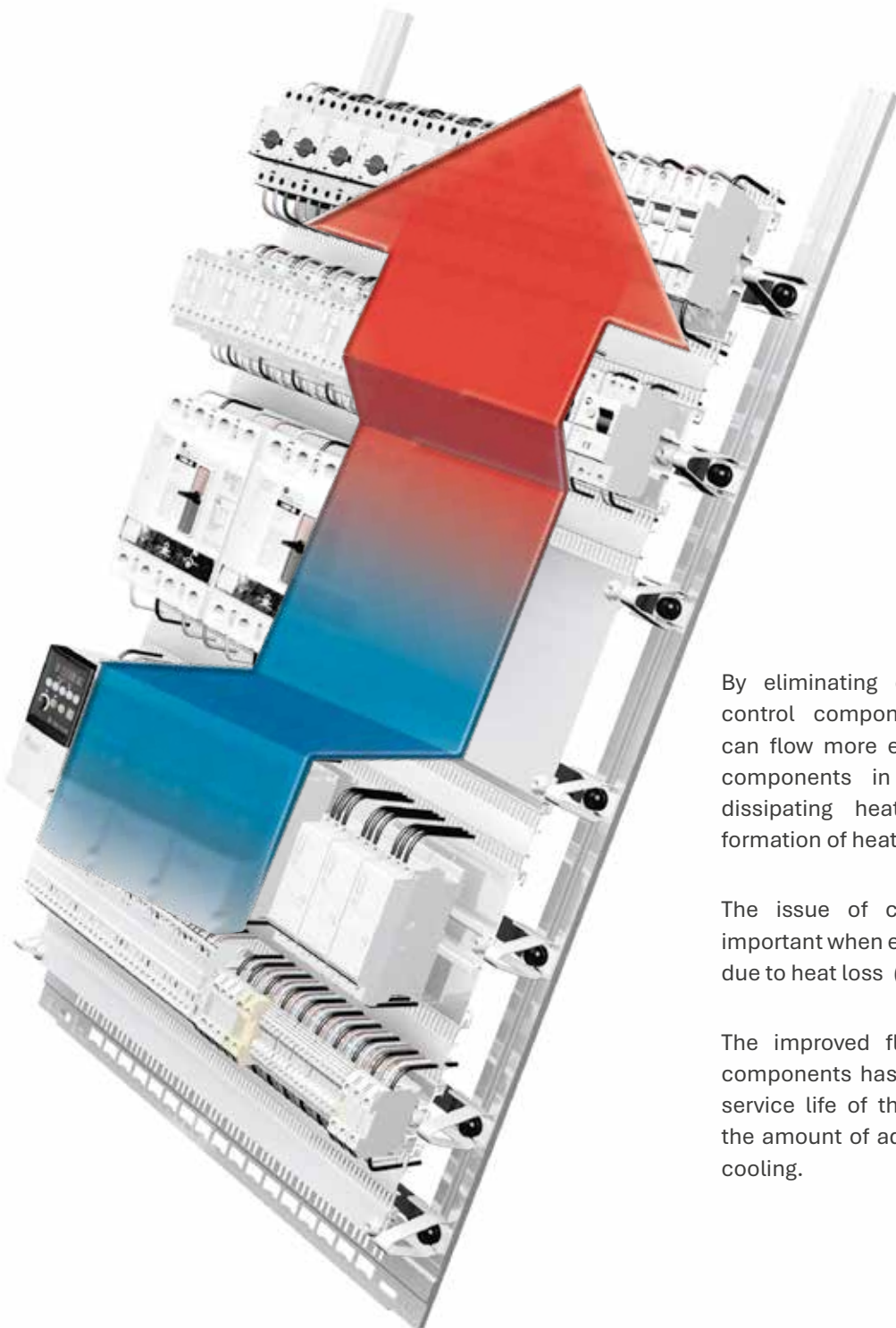

By eliminating cable ducts between the control components, the 'circulating air' can flow more easily around the individual components in the first instance, thus dissipating heat loss more easily; the formation of heat pockets is reduced.

The issue of component temperature is important when excessive temperatures arise due to heat loss ( $>35^{\circ}\text{C}$ ).

The improved flow behaviour around the components has been proven to extend the service life of the components and reduce the amount of additional energy required for cooling.





As a strategic partner, we accompany our customers from the initial idea to perfect implementation – efficiently, innovatively and always one step ahead. Take advantage of our expertise! Contact us now – we look forward to hearing from you!

## Promet AG Switzerland

Promet AG  
Gähwilerstrasse 56  
CH-9533 Kirchberg SG

+41 71 923 25 25

[info@promet.com](mailto:info@promet.com)

## Promet GmbH Germany

Promet GmbH  
Neugablonzer Strasse 11  
DE-93073 Neutraubling BY

+49 9401 912 8646

[info@promet.com](mailto:info@promet.com)



**We are here for you.**  
Personal, reliable and solution-oriented.