



BUSBARS AND ACCESSORIES

PROMET - GROUP

Promet, with its headquarter in Kirchberg, Switzerland and another production site in Germany, is the specialist in engineering solutions for the energy industry and control technology. At all locations, Promet uses the most modern technologies in production. Innovative concepts and solutions can be implemented efficiently and with minimum cost. Thanks to the latest methods, Promet is able to optimize product features and to reduce the costs of the final product significantly.

PROMET GLOBAL



HISTORY

Since the founding of Promet, enthusiasm for energy and control technology has flowed into our ideas. Thanks to our extensive know-how, we are able to efficiently implement ambitious projects. We rely on the latest technologies in the global production of small and large series.

QUALITY

As a Swiss company, we meet the high quality requirements of the solar, energy and wind power industry as well as those of the machine and railway industry.



SAFETY AND ENVIRONMENT

We have committed to constantly being on the cutting edge of technology. Safety and environmental aspects are paramount in the process.

BUSBARS

As one of the largest busbar producer in Europe, we support our local and global customers in the selection of a suitable conductive material, in the design of the products and the optimization of costs. With innovative methods of production and a fully automated machine outfit, we help you to increase your efficiency. International production sites enable an optimal price-performance ratio, as well as logistics concepts that go far beyond conventional solutions.

FULLY AUTOMATED PRODUCTION OF BUSBARS

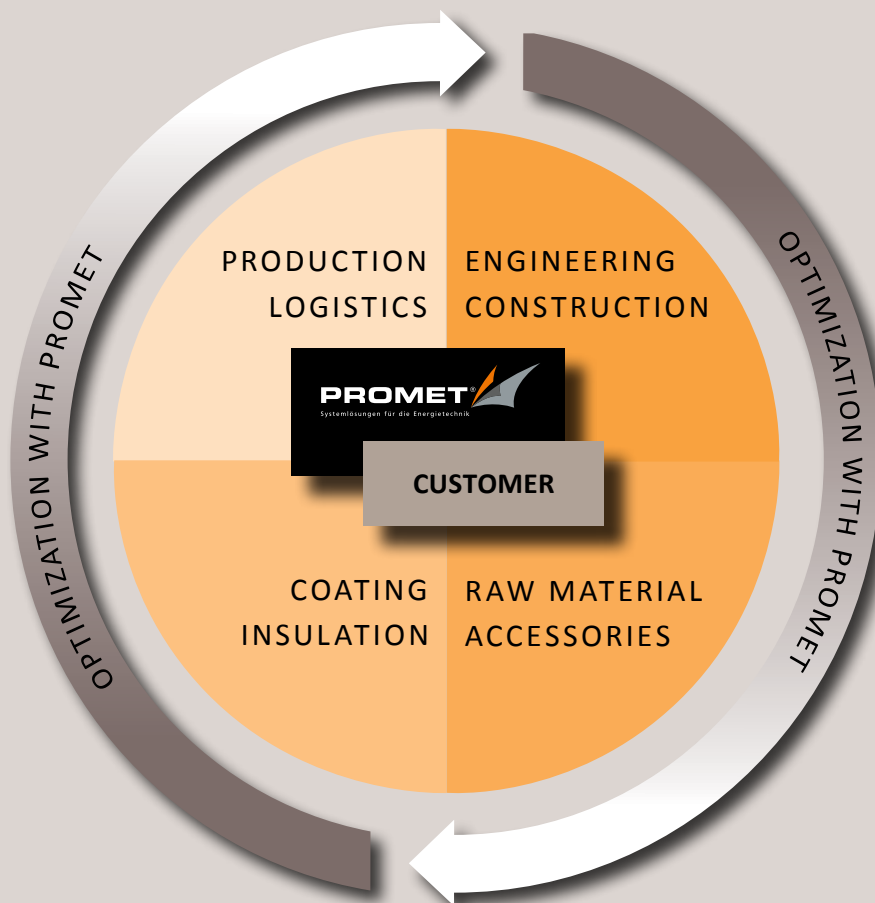
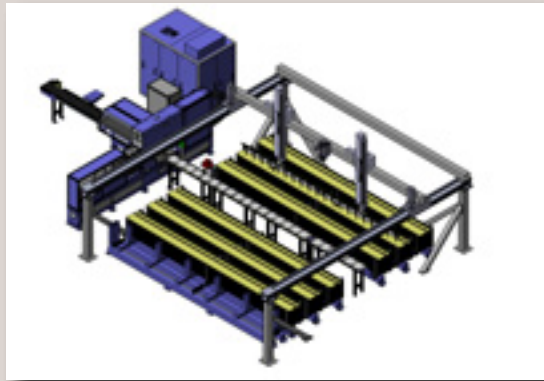
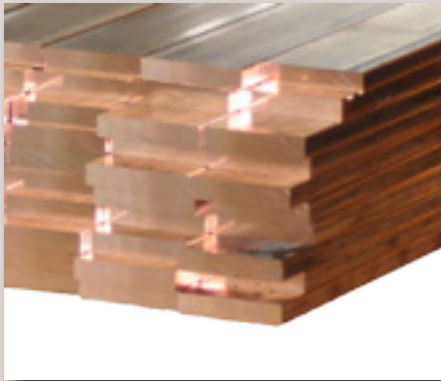

EVERYTHING FROM ONE SOURCE

TECHNICAL ADVICE

Personal technical advice with optimizations

ENGINEERING

Develop products together successfully

CUSTOMIZED PRODUCTION

First sample production, special production and express production

SERIES PRODUCTION

Fully automatic series production

YOU SAVE EXPENSES BY CHOOSING THE RIGHT CONDUCTIVE MATERIAL

The decision regarding which material is used depends on various factors. Promet supports you in choosing the suitable material for your purpose.

We advise you with the goal of achieving an optimal cost-performance ratio while taking into account the market prices of raw materials and find the appropriate material for you as concerns the physical factors of conductivity, machining options, degree of hardness and weight. You increase your efficiency with our innovative production methods.

Copper (Cu-ETP)

Example bars: 40x10mm

- Current load: 715 A
- Weight: 1,108 kg
- Conductivity: 57m/Ωx mm²



Aluminum composite (AlC)

Example bars: 40x10mm

- Current load: 617 A
- Weight: 0.438 kg
- Conductivity: 38m/Ωx mm²



Aluminum (Al)

Example bars: 40x10mm

- Current load: 557 A
- Weight: 0.340 kg
- Conductivity: 34m/Ωx mm²



| Material | Cu-ETP | Cu-OFE | Cuponal | Al pure 1350 | Al 6101 B T6 |
|--|-----------------|-----------------|---------------|-----------------|--------------|
| Features | | | | | |
| Engineering / interpretation | DIN 43671 | DIN 43671 | DIN 43670 | DIN 43671 | DIN 43671 |
| Conductivity [(m/(Ω*mm ²))] at +20°C | 57 | 58 – 59.1 | 38 | 34 - 35 | 30 |
| Weight [kg/m, reference 100x10mm] | 8.9 | 8.9 | 3.6 | 2.72 | 2.72 |
| Costs | High | High | Average | Moderate | Moderate |
| Volatility of stock exchange | High | High | Moderate | Moderate | Moderate |
| Availability | Worldwide stock | Worldwide stock | EU from stock | Worldwide stock | Customized |
| Construction | Very good | Very good | Very good | Sehr gut | Difficult |
| Mechanical processing | Very good | Very good | Very good | Good | Good |
| Bendability | Very good | Very good | Very good | Very good | Difficult |
| Flow behavior | Very good | Very good | Good | Moderate | Good |
| Handling | Good | Good | Good | Very good | Good |
| Surface coating | Very good | Very good | Good | Good | Difficult |
| Welding | Demanding | Very good | Good | Good | Demanding |
| Brazing / Soldering | Good | Very good | Good | Good | Demanding |

EFFICIENCY INCREASE THROUGH INNOVATIVE PROCESS ENGINEERING

Standard busbars

3 bars with screw connections

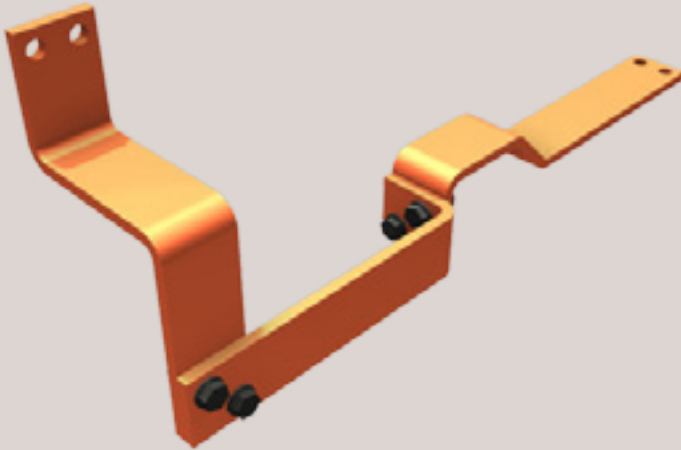

Promet 3D busbars

All in one piece

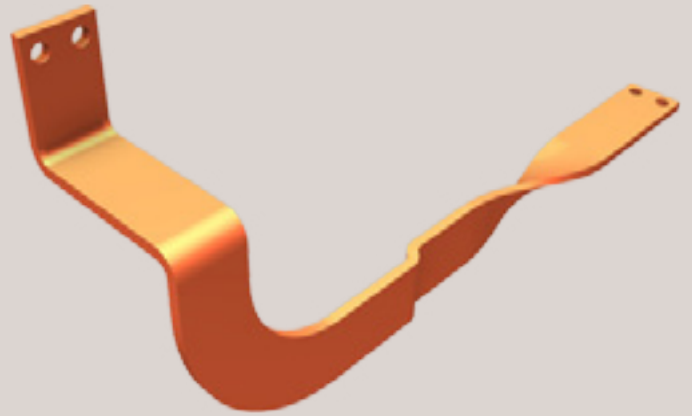

**Cost reduction: 25% less material requirements
and 50% less mounting accessories**

Shorter assembly time and easy storage

Increases the service life and risk minimization

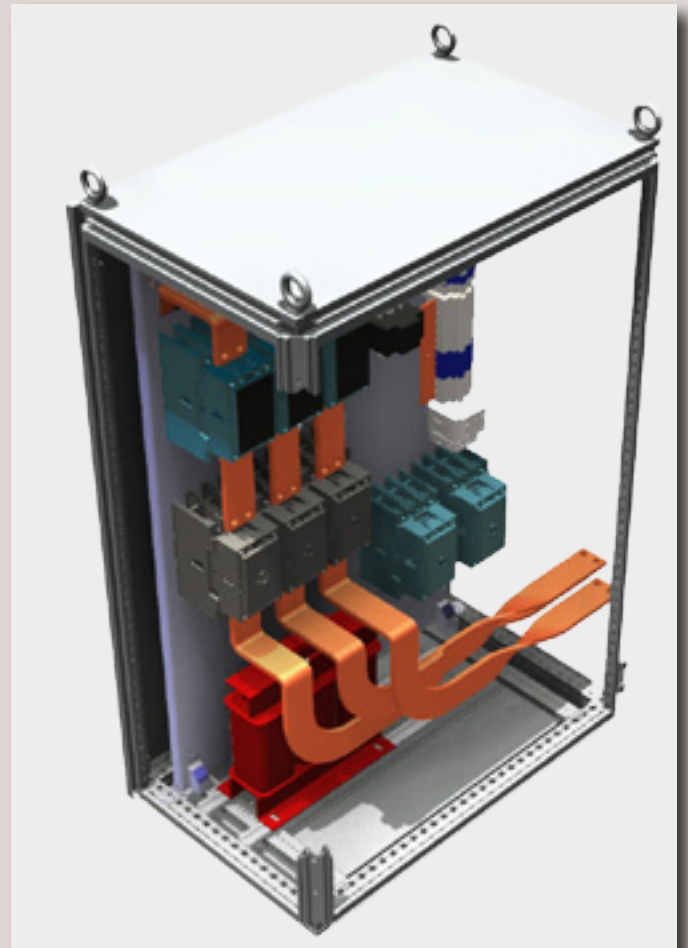
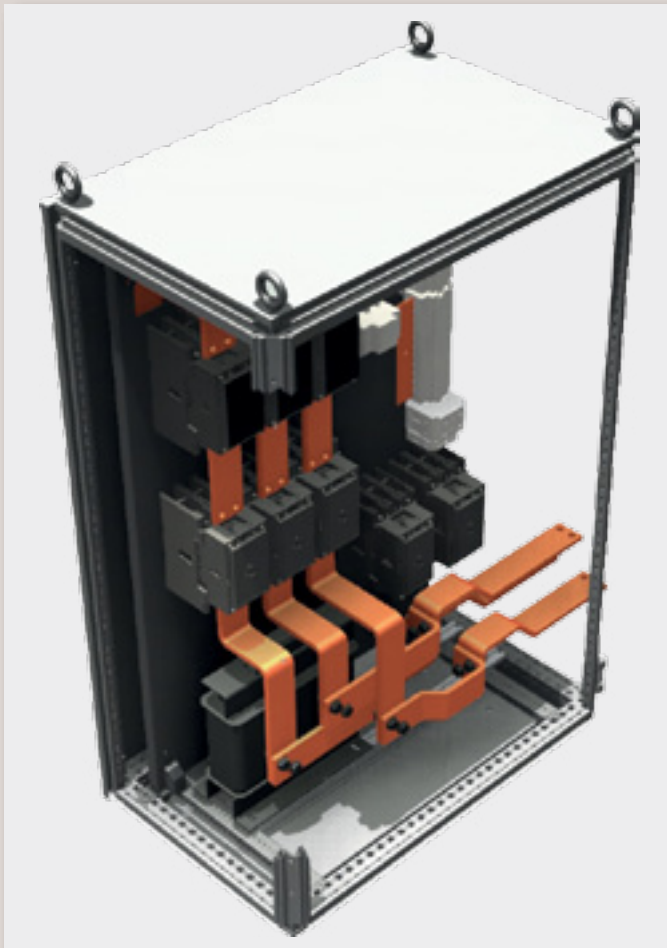

COATINGS AND INSULATIONS

| Coating \ Material | Cu-ETP | Cu-OFE | Cuponal | Al pure 1350 | Al 6101 B T6 |
|--|--------|--------|---------|--------------|--------------|
| Tin | | | | | |
| Nickel | | | | | |
| Silver | | | | | |
| Nickel / Tin | | | | | |
| Elektro less nickel / Tin | | | | | |
| Nickel / Tin Electroplating | | | | | |
| Copper / Tin | | | | | |
| Electro less nickel / Tin Electroplating | | | | | |
| Epoxy Coating | | | | | |
| Insulation coating | | | | | |
| Shrink sleeve | | | | | |
| Coated | | | | | |

| | | |
|--------|----------|--------------|
| Legend | Possible | Not possible |
|--------|----------|--------------|

RAW MATERIALS

Flat busbars and sheets:

- Copper
- Aluminum
- Cuponal / Aluminum composite

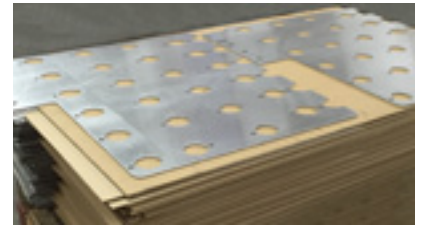

ACCESSORIES

Earthing tapes

- Customized
- Uncoated / tin-coated
- Press welded



Busbar support

- Standard 60 mm and 180 mm system



Insulators

- Resistant
- Easy handling



Flexible copper busbars

- High flexibility
- Wide range of dimensions

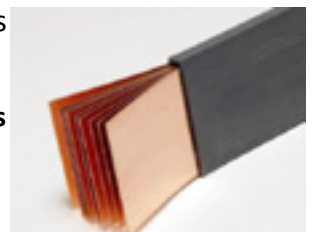

CUSTOMIZED PRODUCTION AND SERVICES

CNC production



Water jet



Laserpress



Cutting plotter



Bending



Punching



ENGINEERING

We offer you comprehensive services in the following areas:

- Development and design
- Consultation and development of technical solutions
- First samples and test reports
- Technical documentation
- 3D model printing
- Design with inventor / EPLAN
- Creation of CAD models and drawings
- Project management and monitoring

MEASUREMENT ACCURACY

With the FARO measurement arm, we can efficiently and quickly measure the key coordinates and compare them directly with the CAD drawing.

- 3D inspections
- Accuracy: from 0.024 mm to 0.064 mm
- Target-actual comparison of product - STEP file
- Flexibility with mobile measuring station
- Installation sizes up to 2.4 m
- Measurement service with documentation



CONTACT



Promet AG - Headquarters

Gähwilerstrasse 56
9533 Kirchberg
Switzerland

tel.: +41 71 923 25 25
fax: +41 71 923 25 21

e-mail: info@promet.com
www.promet.com



Promet GmbH

Neugablonzer Strasse 7
93073 Neutraubling BY
Germany

tel.: +49 9401 912 8646
fax: +49 9401 912 8648

e-mail: verkauf-de@promet.com
www.promet.com

OUR EXPERTISE

